

Pg 21

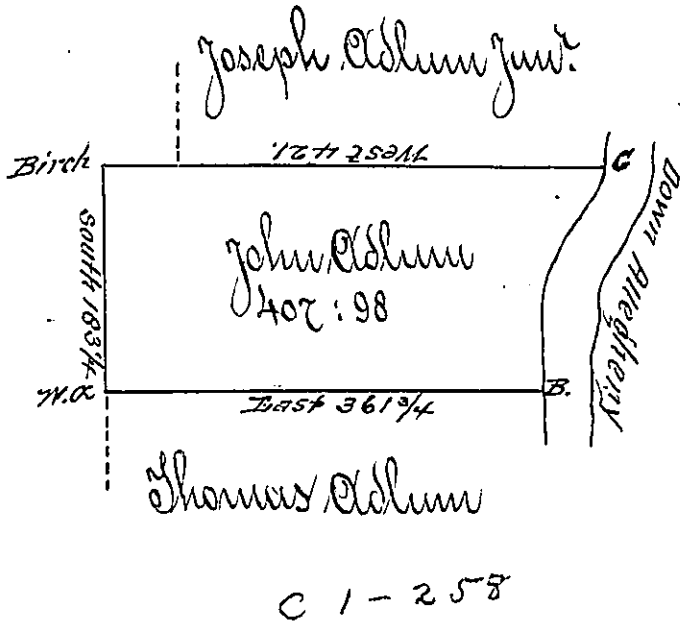

Courses on the River from B. upwards to C

N. 4° W.	10 3/4
N. 6. E.	7
N. 1° E.	23
N. 7° E.	70
N. 16. E.	24
N. 48° E.	48
N. 24° E.	20
202 3/4	

Surveyed on the 24th day of June 1795 the above described Tract of Land in District 986 in pursuance of a Warrant to John Aldum, dated 20th December 1793 containing Four Hundred seven Acres & Twenty Eight Berches and allowance of six per Cent
 To Daniel Brodhead Esq. }
 Surveyor General }
 Saul Nicholson D.D.

IN TESTIMONY that the above is a copy of the original remaining on file in the Department of Internal Affairs of Pennsylvania, made conformably to an Act of Assembly approved the 16th day of February, 1833, I have hereunto set my Hand and caused the Seal of said Department to be affixed at Harrisburg, this second day of September 1902.

James Latta
 Secretary of Internal Affairs.